

CAST IRON- FL-LAGERUNITS- CAST IRON- FL-BEARING UNITS

UCFL 200

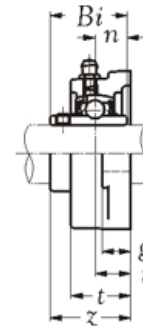

STANDARD DUTY TWO BOLTS FLANGED UNITS CAST HOUSING
SET SCREWS TYPE

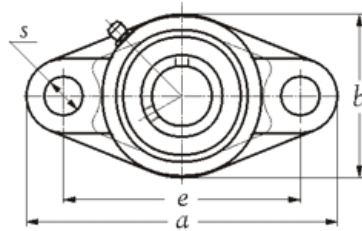

Shaft dia. mm inch	Unit number	Nominal dimensions										Bolt size mm inch	Bearing number	Housing number	Mass of unit Kg				
		a		e		i		g		t						s		b	
12 1/2	UCFL 201	113	90	15	11	25.5	12	60	33.3	31.0	12.7	M 10	UC 201	FL 204	0.47				
	UCFL 201-8	4-29/64	3-35/64	19/32	7/16	1	15/32	2-23/64	1-5/16	1.2205	0.5000	3/8	UC 201-8	FL 204	0.47				
15 9/16 5/8	UCFL 202	113	90	15	11	25.5	12	60	33.3	31.0	12.7	M 10	UC 202	FL 204	0.46				
	UCFL 202-9 UCFL 202-10	4-29/64	3-35/64	19/32	7/16	1	15/32	2-23/64	1-5/16	1.2205	0.5000	3/8	UC 202-9 UC 202-10	FL 204	0.46 0.46				
17 11/16	UCFL 203	113	90	15	11	25.5	12	60	33.3	31.0	12.7	M 10	UC 203	FL 204	0.45				
	UCFL 203-11	4-29/64	3-35/64	19/32	7/16	1	15/32	2-23/64	1-5/16	1.2205	0.5000	3/8	UC 203-11	FL 204	0.45				
20 3/4	UCFL 204	113	90	15	11	25.5	12	60	33.3	31.0	12.7	M 10	UC 204	FL 204	0.43				
	UCFL 204-12	4-29/64	3-35/64	19/32	7/16	1	15/32	2-23/64	1-5/16	1.2205	0.5000	3/8	UC 204-12	FL 204	0.44				
25 13/16 7/8 15/16 1	UCFL 205	130	99	16	13	27.0	16	68	35.7	34.0	14.3	M 14	UC 205	FL 205	0.60				
	UCFL 205-13												UC 205-13		0.64				
	UCFL 205-14	5-1/8	3-57/64	5/8	3/64	1-1/16	5/8	2-43/64	1-13/32	1.3386	0.5630	1/2	UC 205-14	FL 205	0.62				
	UCFL 205-15 UCFL 205-16												UC 205-15 UC 205-16		0.61 0.59				
30 1-1/16 1-1/8 1-3/16 1-1/4	UCFL 206	148	117	18	13	31.0	16	80	40.2	38.1	15.9	M 14	UC 206	FL 206	0.91				
	UCFL 206-17												UC 206-17		0.95				
	UCFL 206-18	5-53/64	4-39/64	45/64	3/64	1-7/32	5/8	3-5/32	1-37/64	1.5000	0.6260	1/2	UC 206-18	FL 206	0.93				
	UCFL 206-19 UCFL 206-20												UC 206-19 UC 206-20		0.90 0.89				
35 1-1/4 1-5/16 1-3/8 1-7/16	UCFL 207	161	130	19	14	34.0	16	90	44.4	42.9	17.5	M 14	UC 207	FL 207	1.14				
	UCFL 207-20												UC 207-20		1.20				
	UCFL 207-21	6-11/32	5-1/8	3/4	35/64	1-11/32	5/8	3-35/64	1-3/4	1.6890	0.6890	1/2	UC 207-21	FL 207	1.18				
	UCFL 207-22 UCFL 207-23												UC 207-22 UC 207-23		1.15 1.12				
40 1-1/2	UCFL 208	175	144	21	14	36.0	16	100	51.2	49.2	19.0	M 14	UC 208	FL 208	1.43				
	UCFL 208-24	6-57/64	5-43/64	53/64	35/64	1-27/64	5/8	3-15/16	2-1/64	1.9370	0.7480	1/2	UC 208-24	FL 208	1.47				
45 1-5/8 1-11/16 1-3/4	UCFL 209	188	148	22	16	38.0	19	108	52.2	49.2	19.0	M 16	UC 209	FL 209	1.80				
	UCFL 209-26												UC 209-26		1.90				
	UCFL 209-27	7-13/32	5-53/64	55/64	5/8	1-1/2	3/4	4-1/4	2-1/16	1.9370	0.7480	5/8	UC 209-27	FL 209	1.86				
	UCFL 209-28												UC 209-28		1.82				
50 1-7/8 1-15/16 2	UCFL 210	197	157	22	16	40.0	19	115	54.6	51.6	19.0	M 16	UC 210	FL 210	2.13				
	UCFL 210-30												UC 210-30		2.20				
	UCFL 210-31	7-3/4	6-3/16	55/64	5/8	1-37/64	3/4	4-17/32	2-5/32	2.0315	0.7480	5/8	UC 210-31	FL 210	2.15				
	UCFL 210-32												UC 210-32		2.11				
55 2 2-1/16 2-1/8 2-3/16	UCFL 211	224	184	25	18	43.0	19	130	58.4	55.6	22.2	M 16	UC 211	FL 211	2.86				
	UCFL 211-32												UC 211-32		3.01				
	UCFL 211-33	8-13/16	7-1/4	63/64	45/64	1-11/16	3/4	5-1/8	2-19/64	2.1890	0.8740	5/8	UC 211-33	FL 211	2.96				
	UCFL 211-34												UC 211-34		2.91				
	UCFL 211-35												UC 211-35		2.84				
60 2-1/4 2-5/16 2-3/8 2-7/16	UCFL 212	250	202	29	18	48.0	23	140	68.7	65.1	25.4	M 20	UC 212	FL 212	3.76				
	UCFL 212-36												UC 212-36		3.90				
	UCFL 212-37	9-27/32	7-61/64	1-9/64	45/64	1-57/64	29/32	5-3/64	2-45/64	2.5630	1.0000	3/4	UC 212-37	FL 212	3.83				
	UCFL 212-38												UC 212-38		3.74				
	UCFL 212-39												UC 212-39		3.68				