

CAST IRON V-BELT PULLEY SPB-2 ISO 4183 / DIN 2211-3

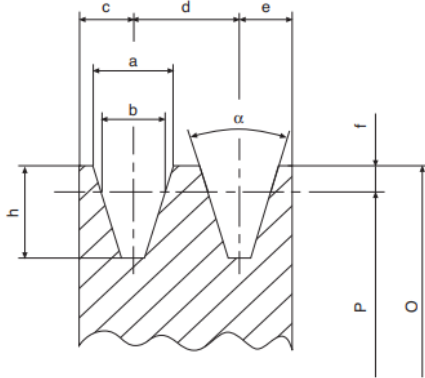

Calcolo della velocità periferica Vp in m/s
Calculation of peripheral speed Vp in m/s
Berechnung der Umfangsgeschwindigkeit Vp in m/s
Calcul de la vitesse périphérique Vp m/s
Cálculo de la velocidad periférica Vp en m/s

$$V_p = \frac{p \cdot P \cdot \text{rpm}}{60 \cdot 1000} @ \frac{P \cdot \text{rpm}}{19100} \quad V_p \leq 35 \text{ m/s}$$

P = Diametro primitivo in mm rpm = Giri al minuto
 Pitch diameter in mm Revolutions per minute
 Teildurchmesser in mm Umdrehungen pro Minute
 Diamètre primitif en mm Tours par minute
 Diámetro primitivo en mm Revoluciones por minuto

Dimensioni puleggia Pulley dimentionts Keilriemenschei- Dimensions poulie Dimensiones polea
benabmessungen

| | a | b | c | d | e | f | h | 34° | 38° |
|-----|------|------|------|------|------|-----|------|----------|---------|
| SPZ | 9,7 | 8,5 | 8,0 | 12,0 | 8,0 | 2,0 | 11,0 | P <= 80 | P > 80 |
| SPA | 12,7 | 11,0 | 10,0 | 15,0 | 10,0 | 2,8 | 13,8 | P <= 118 | P > 118 |
| SPB | 16,3 | 14,0 | 12,5 | 19,0 | 12,5 | 3,5 | 17,5 | P <= 190 | P > 190 |
| SPC | 22,0 | 19,0 | 17,0 | 25,5 | 17,0 | 4,8 | 23,8 | P <= 315 | P > 315 |

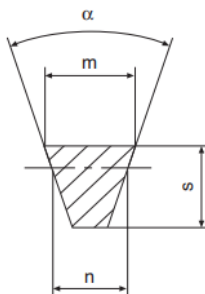

Dimensioni cinghia / Belt dimentionts / Riemenabmessungen
Dimensions courroie / Dimensiones correa

| | m | s | n |
|-----|------|----|------|
| SPZ | 9,7 | 8 | 8,5 |
| SPA | 12,7 | 10 | 11,0 |
| SPB | 16,3 | 13 | 14,0 |
| SPC | 22,0 | 18 | 19,0 |

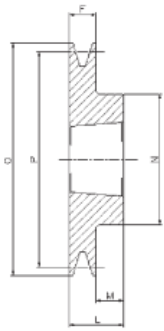

1

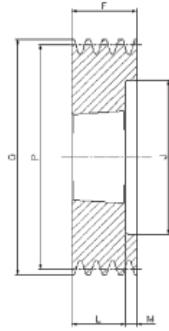

2

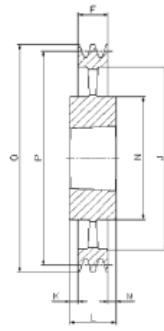

4

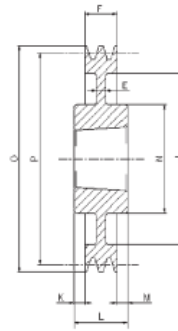

7

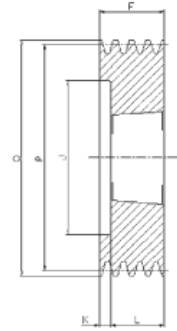

8

SPB/2

| Tipo Type Typ Type Tipo | Gole Grooves Rillen Gorges Canales | P | O | Forma Form Forme Forme Forma | Bussola Bush Buchse Moyeu Casquillo | Ø MAX | E | F | J | K | L | M | N |
|-------------------------------------|--|-----|-----|--|---|----------|----|----|-----|------|----|------|-----|
| SPB100-02 | 2 | 100 | 107 | 8 | 1610 | 42 | - | 44 | 62 | 19,0 | 25 | - | - |
| SPB106-02 | 2 | 106 | 113 | 8 | 1610 | 42 | - | 44 | 67 | 19,0 | 25 | - | - |
| SPB112-02 | 2 | 112 | 119 | 8 | 1610 | 42 | - | 44 | 72 | 19,0 | 25 | - | - |
| SPB118-02 | 2 | 118 | 125 | 2 | 1610 | 42 | - | 44 | 78 | - | 25 | 19,0 | - |
| SPB125-02 | 2 | 125 | 132 | 2 | 2012 | 50 | - | 44 | 82 | - | 32 | 12,0 | - |
| SPB132-02 | 2 | 132 | 139 | 2 | 2012 | 50 | - | 44 | 89 | - | 32 | 12,0 | - |
| SPB140-02 | 2 | 140 | 147 | 2 | 2012 | 50 | - | 44 | 97 | - | 32 | 12,0 | - |
| SPB150-02 | 2 | 150 | 157 | 2 | 2012 | 50 | - | 44 | 107 | - | 32 | 12,0 | - |
| SPB160-02 | 2 | 160 | 167 | 2 | 2012 | 50 | - | 44 | 117 | - | 32 | 12,0 | - |
| SPB170-02 | 2 | 170 | 177 | 2 | 2012 | 50 | - | 44 | 127 | - | 32 | 12,0 | - |
| SPB180-02 | 2 | 180 | 187 | 1 | 2517 | 60 | - | 44 | - | - | 45 | 1,0 | 120 |
| SPB190-02 | 2 | 190 | 197 | 1 | 2517 | 60 | - | 44 | - | - | 45 | 1,0 | 120 |
| SPB200-02 | 2 | 200 | 207 | 1 | 2517 | 60 | - | 44 | - | - | 45 | 1,0 | 117 |
| SPB212-02 | 2 | 212 | 219 | 7 | 2517 | 60 | 20 | 44 | 169 | - | 45 | 1,0 | 117 |
| SPB224-02 | 2 | 224 | 231 | 7 | 2517 | 60 | 15 | 44 | 181 | - | 45 | 1,0 | 117 |
| SPB236-02 | 2 | 236 | 243 | 7 | 2517 | 60 | 15 | 44 | 193 | - | 45 | 1,0 | 117 |
| SPB250-02 | 2 | 250 | 257 | 7 | 2517 | 60 | 20 | 44 | 207 | - | 45 | 1,0 | 125 |
| SPB280-02 | 2 | 280 | 287 | 7 | 2517 | 60 | 20 | 44 | 237 | - | 45 | 1,0 | 125 |
| SPB300-02 | 2 | 300 | 307 | 7 | 2517 | 60 | 20 | 44 | 257 | - | 45 | 1,0 | 125 |
| SPB315-02 | 2 | 315 | 322 | 7 | 2517 | 60 | 20 | 44 | 272 | - | 45 | 1,0 | 125 |
| SPB335-02 | 2 | 335 | 342 | 7 | 2517 | 60 | 20 | 44 | 292 | - | 45 | 1,0 | 125 |
| SPB355-02 | 2 | 355 | 362 | 7 | 3020 | 75 | 15 | 44 | 312 | 3,5 | 51 | 3,5 | 144 |
| SPB400-02 | 2 | 400 | 407 | 4 | 3020 | 75 | - | 44 | 357 | 3,5 | 51 | 3,5 | 150 |
| SPB450-02 | 2 | 450 | 457 | 4 | 3020 | 75 | - | 44 | 407 | 3,5 | 51 | 3,5 | 150 |
| SPB500-02 | 2 | 500 | 507 | 4 | 3020 | 75 | - | 44 | 457 | 3,5 | 51 | 3,5 | 150 |
| SPB560-02 | 2 | 560 | 567 | 4 | 3030 | 75 | - | 44 | 517 | 4,0 | 76 | 28,0 | 150 |
| SPB630-02 | 2 | 630 | 637 | 4 | 3030 | 75 | - | 44 | 587 | 16,0 | 76 | 16,0 | 150 |