

## RVS SA-LAGERINSERTS- SS SA-BEARING INSERTS

TRADA RVS lagerinserts worden geproduceerd van hoge kwaliteit RVS. RVS lagerinserts kunnen worden ingezet in een corrosie rijke omgeving. Dankzij het hoogwaardige RVS, wordt de levensduur verlengd ten opzichte van andere lagers. Het RVS lagerinsert wordt geproduceerd met FM222 vet, wat de lagers voedselveilig maakt. Lagers zijn te gebruiken van -20°C tot +120°C.

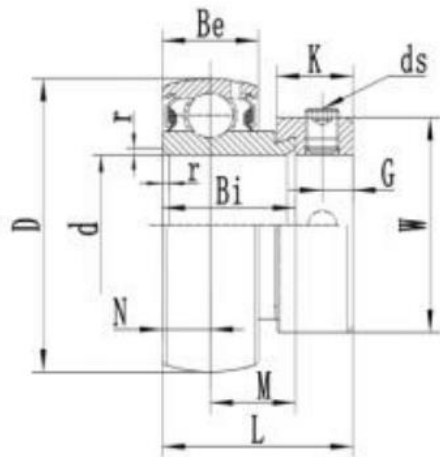

Bearing No.	Bore Di a		Dimensions (mm)										Basic Load Rating (kN)	Basic Static Load Rating (kN)	Weight (kg)	
	d		D	Bi	Be	r	N	M	L	W	K	G				ds
	in	mm														
SSA201	1/2	12	40	19.1	12	0.8	6	13.1	28.6	28.6	13.5	5	M6×0.75	7.84	3.58	0.12
SSA201-8		15											1/4-28			0.14
SSA202	5/8	15	40	19.1	12	0.8	6	13.1	28.6	28.6	13.5	5	M6×0.75	7.84	3.58	0.11
SSA202-10		17											1/4-28			0.13
SSA203	11/16	17	40	19.1	12	0.8	6	13.1	28.6	28.6	13.5	5	M6×0.75	7.84	3.58	0.10
SSA203-11		17											1/4-28			0.12
SSA204	3/4	20	47	21.5	14	1	7	14.5	31	33.3	13.5	5	M6×0.75	10.37	5.04	0.15
SSA204-12		20											1/4-28			0.16
SSA205	7/8	25	52	21.5	15	1.2	7.5	14	31	38.1	13.5	5	M6×0.75	11.31	5.97	0.18
SSA205-14		15/16											1/4-28			0.21
SSA205-15	1	25	52	21.5	15	1.2	7.5	14	31	38.1	13.5	5	1/4-28	11.31	5.97	0.19
SSA205-16		1											1/4-28			0.18
SSA206	1-1/16	30	62	23.8	16	1.2	8	15.8	35.7	44.5	15.9	6	M8×1	15.73	8.64	0.30
SSA206-17		1-1/8											5/16-24			0.34
SSA206-18	1-3/16	30	62	23.8	16	1.2	8	15.8	35.7	44.5	15.9	6	5/16-24	15.73	8.64	0.32
SSA206-19		1-1/4											5/16-24			0.30
SSA206-20	1-1/4	30	62	23.8	16	1.2	8	15.8	35.7	44.5	15.9	6	5/16-24	15.73	8.64	0.29
SSA207	1-1/4	35	72	25.4	17	1.5	8.5	16.9	38.9	55.6	17.5	6.5	M8×1	20.83	11.68	0.50
SSA207-20		1-5/16											5/16-24			0.55
SSA207-21	1-3/8	35	72	25.4	17	1.5	8.5	16.9	38.9	55.6	17.5	6.5	5/16-24	20.83	11.68	0.53
SSA207-22		1-7/16											5/16-24			0.50
SSA207-23	1-7/16	35	72	25.4	17	1.5	8.5	16.9	38.9	55.6	17.5	6.5	5/16-24	20.83	11.68	0.47
SSA208	1-1/2	40	80	30.2	18	1.5	9	21.2	43.7	60.3	18.3	6.5	M8×1	23.55	13.6	0.63
SSA208-24		1-9/16											5/16-24			0.67
SSA208-25	1-9/16	40	80	30.2	18	1.5	9	21.2	43.7	60.3	18.3	6.5	5/16-24	23.55	13.6	0.65
SSA209	1-5/8	45	85	30.2	19	1.8	9.5	20.7	43.7	63.5	18.3	6.5	M8×1	26.44	19.56	0.66
SSA209-26		1-11/16											5/16-24			0.74
SSA209-27	1-3/4	45	85	30.2	19	1.8	9.5	20.7	43.7	63.5	18.3	6.5	5/16-24	26.44	19.56	0.72
SSA209-28		1-3/4											5/16-24			0.67
SSA210	1-13/16	50	90	30.2	20	1.8	10	20.2	43.7	69.9	18.3	6.5	M8×1	30.01	22.53	0.80
SSA210-29		1-7/8											3/8-24			0.90
SSA210-30	1-15/16	50	90	30.2	20	1.8	10	20.2	43.7	69.9	18.3	6.5	3/8-24	30.01	22.53	0.86
SSA210-31		2											3/8-24			0.83
SSA210-32	2	50	90	30.2	20	1.8	10	20.2	43.7	69.9	18.3	6.5	3/8-24	30.01	22.53	0.79
SSA211	2	55	100	32.5	21	2	10.5	22	48.4	76.2	20.7	8	M10×1.25	32.39	24	0.77
SSA211-32		2-1/16											3/8-24			0.95
SSA211-33	2-1/6	55	100	32.5	21	2	10.5	22	48.4	76.2	20.7	8	3/8-24	32.39	24	0.91
SSA211-34		2-3/16											3/8-24			0.86
SSA211-35	2-3/16	55	100	32.5	21	2	10.5	22	48.4	76.2	20.7	8	3/8-24	32.39	24	0.81
SSA212	2-1/4	60	110	37.2	22	2	11	26.2	53.1	84.2	22.3	8	M10×1.25	35.28	26.18	0.99
SSA212-36		2-5/16											3/8-24			1.00
SSA212-37	2-3/8	60	110	37.2	22	2	11	26.2	53.1	84.2	22.3	8	3/8-24	35.28	26.18	0.99
SSA212-38		2-7/16											3/8-24			0.99
SSA212-39	2-7/16	60	110	37.2	22	2	11	26.2	53.1	84.2	22.3	8	3/8-24	35.28	26.18	0.98